

MARK	DATE	EXPLANATION	REVISER
▽	20140805	Modified electroplating numbe	JACKY LIU
▽	20190123	Add "Nexttron" LOGO and Nut post height	JACKY LIU

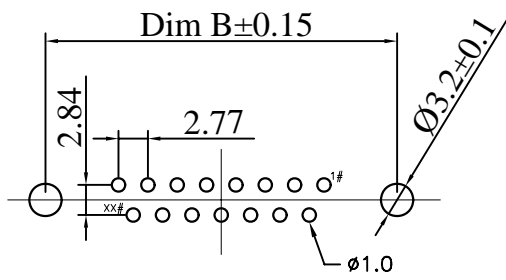
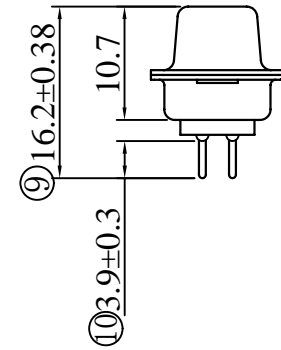
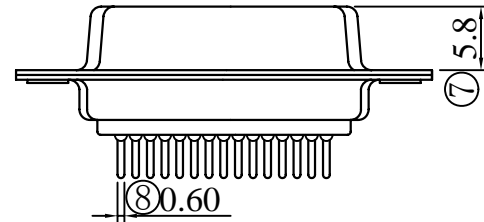
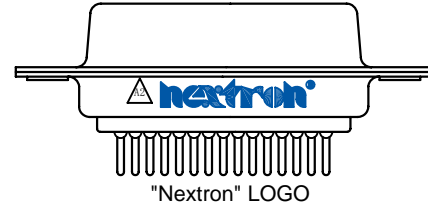
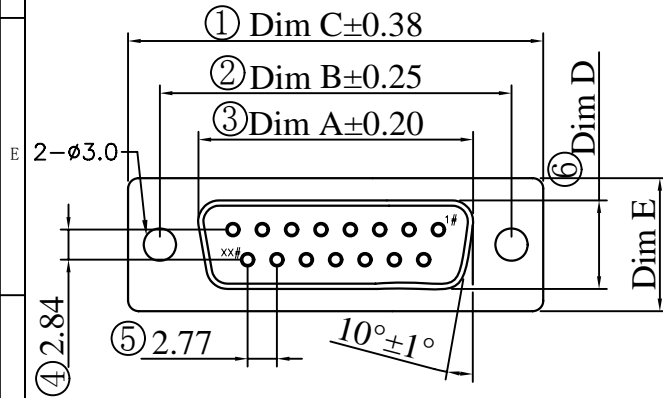

37P	54.84	63.50	69.32	7.90	12.50
25P	38.38	47.04	53.04	7.90	12.50
15P	24.66	33.32	39.14	7.90	12.50
9P	16.33	24.99	30.81	7.90	12.50
POS. NO.	A	B	C	D	E

### SPECIFICATIONS:

Current rating:3.0A AC/DC  
Voltage rating:250V AC/DC  
Contact resistance:30m ohm MAX  
Insulation resistance:1000M ohm MIN  
Withstanding voltage:1000V AC for one minute  
Operating temperature range:-40°C~+85°C  
Thread specification of nut:#4-40UN

### MATERIAL AND FINISH

Insulator:PBT+30%G.F(UL94V-0)  
Contact:Copper Alloy Nickel Undercoated  
Selective Gold Plated  
Finish:Metal Iron With Tin Plated

## Ordering Information

SUB		DPXF		XXXX		XXX			
Number of contacts	Housing Type	Mounting Options		Nut post height	Contacts Material	Contact Plated	Insulator material	Insulator color	Mark
Code Definition	Code Definition	Code Definition	Code Definition	Code Definition	Code Definition	Code Contact Area	Code Definition	Code Definition	Code Definition
A 9 PIN	M Male	1 RIVETED W/ SHIELD ONLY	0 H=5.8mm	2 Brass	1 Full Gold 1u"	0 PBT	0 Black	0 NONE	
B 15 PIN	F Female	2 RIVETED W/ FRONT RIVET	1 H=4.8mm	7 Phosphor bronze	2 Gold 3u"	2 NYLON	6 Blue	2 Nexttron	
C 25 PIN		3 RIVETED W/ REAR RIVET			3 Gold 5u"		9 White		
E 37 PIN		4 RIVETED W/ NUT RIVET			4 Gold 10u"				
		5 RIVETED W/ HEX SCREW +HEX NUT			5 Gold 15u"				
					6 Gold 30u"				

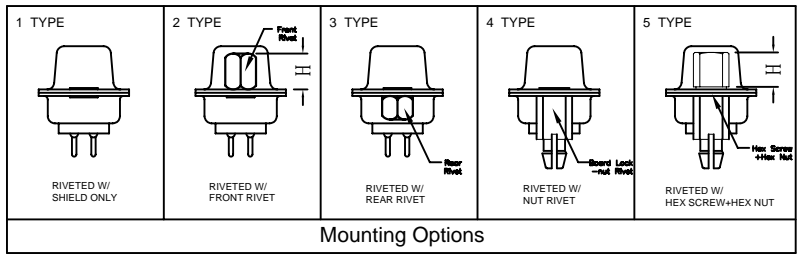

**JHJM** 深圳市君灏精密工业有限公司  
SHENZHEN JUNHAO ENGINEERING CO., LTD

PART. NAME:	D型XX芯直插式PCB焊接插座 (孔)	TITLE:	D-SUB/DP/XXP/FEMALE/
PART. NO.:	SEE TABLE	DWG NAME:	C-SUB-DP0F-0001
APPROVED BY:	CHECKED BY:	DESIGNED BY:	DRAWN BY:
Jonsson	Jeff	allan	Jacky
		2019.01.25	
CUSTOM NO.:		Tolerance	
		x. ±0.50	
		x.x ±0.30	
		SCALE: x.xx ±0.20	
		xx° ±1°	